



# Invasive Species in Metro Vancouver

## OF GROWING INTEREST...

**Laurie Bates-Frymel**

SENIOR REGIONAL PLANNER, ELECTORAL AREA,  
PLANNING ANALYTICS AND ENVIRONMENT

Sustainability Community Breakfast, June 7, 2017

21866895



**metrovancover**  
SERVICES AND SOLUTIONS FOR A LIVABLE REGION





# What is an invasive species?

A non-native organism whose introduction can cause harm to the *environment, human health* or *economic* interests.

-- Centre for Invasive Species and Ecosystem Health





Canada thistle

Agriculture





Purple loosestrife

# Biodiversity and ecological health



Japanese knotweed

Property / Infrastructure





Giant hogweed

Public health

# Our Changing Climate



## Impacts:

- Different plants and pests will thrive
- Existing invasive species will expand range
- New invasive species could take hold



# Who has a role?

- Everyone...
  - Federal Government
  - Provincial Government
  - Local Governments
  - Weed Committees/Councils  
(e.g., Invasive Species Council of Metro Vancouver)
  - Right-of-way holders
  - Businesses
  - Public







# Metro Vancouver's role

- Land manager
  - Regional Parks
  - Watersheds
  - Facilities
- Regional collaboration and coordination
  - Regional Invasive Species Task Force

# Some invasive species in Metro Vancouver

## Flora

- Giant hogweed\*
- Knotweeds (Japanese, giant, bohemian, Himalayan)\*
- Purple loosestrife\*
- Canada thistle\*
- Yellow flag iris\*
- Garlic mustard\*
- Wild chervil\*
- Common tansy\*
- Spartina / cordgrass\*
- Gorse\*
- Himalayan and cut leaf blackberry
- Scotch broom
- Himalayan balsam / Policeman's helmet
- Orange hawkweed
- English holly
- English ivy
- Butterfly bush
- Common periwinkle
- Yellow archangel / lamium
- Daphne / spurge-laurel
- Many more...

## Fauna

- European chafer beetles
- Fire ants (European and Impressive)
- Grey squirrel



Common tansy



European fire ants



## Homegrown Beauty

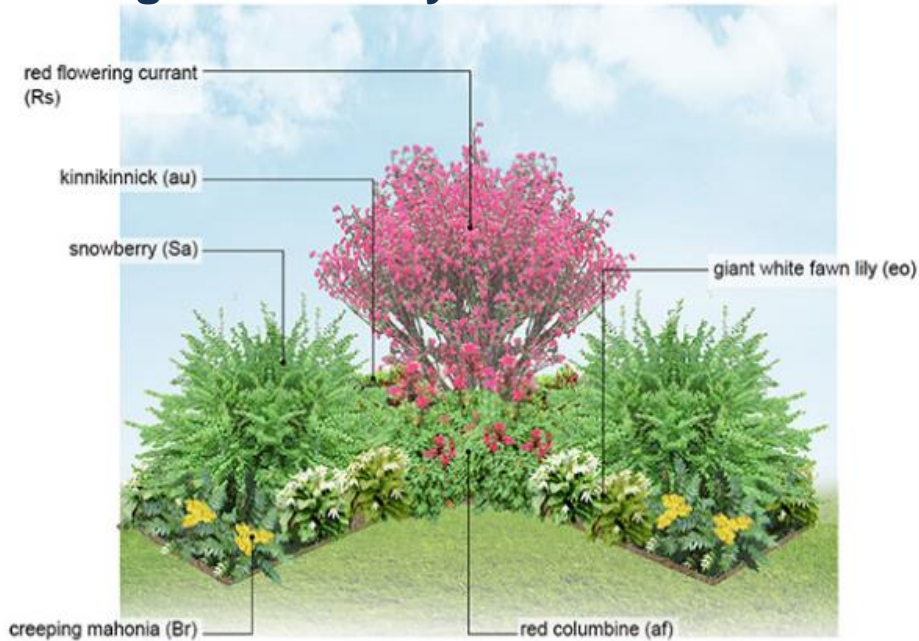

## Spring Sunshine

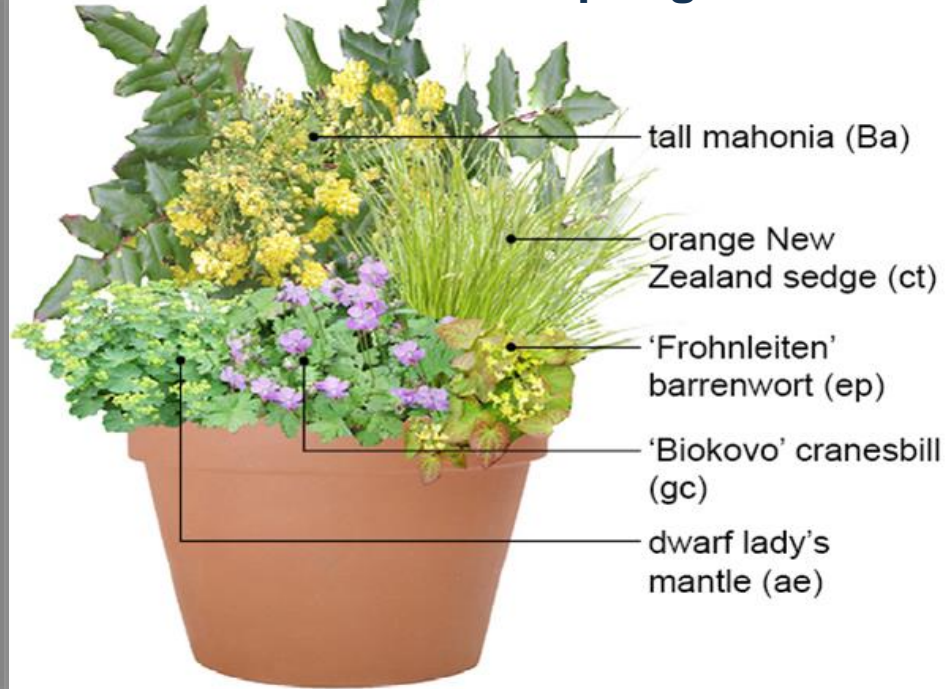

## Grow Green website

- No invasive plants and many designs feature native plants

## Garden Tips

Metro Vancouver makes sustainable gardening easier than ever – with helpful tips, sensible advice, and lots of online resources for healthy lawns and gardens. Check back often, we're always adding more great content!

### TACKLING INVASIVE SPECIES

Invasive species can have economic, human health, and environmental impacts. It can be expensive for local governments to remove and control fast-spreading invasive species. Some, like giant hogweed with its toxic sap, can injure people and pets, and local plants can be crowded out by fast-growing invasives that compete for space in the eco-system. Many people may not even realize they have invasive plants in their yard, such as traditional favourites like periwinkle or English Ivy.

You can help win the fight against invasive species through careful plant choices and removal of existing invasives in your yard. Visit the links to learn which plants are considered invasive in our region, how to identify them, and alternatives to consider for your garden. To control the spread of non-native plant species, make sure you dispose of them in your garbage bin rather than putting them in the compost.

#### Additional Resources

##### [Invasive Species Council of British Columbia](#)

This organization is committed to reducing the impact of invasive species in our province. Fact sheets, plant identification guides and other useful resources can be found on their website.

##### [Invasive Species Council of Metro Vancouver](#)

One of the seventeen regional invasive species committees in the province, the ISCMV offers education and outreach





Thank you